



High Halstow TIMES

Home of the Heron



November 2014

Medway Council
Empowering Communities focused on the
Hoo Peninsula

Location: High Halstow Village Hall
Date: 6th November 2014
Time: 10:00am

Combining Personalisation with Community Empowerment. Medway Council working with DERiC to find new ways to support isolated or vulnerable adults and families.

Medway Council would be really pleased to see people who have first hand experience of receiving social care services, carers of disabled children and adults, volunteers and outreach workers, owners and managers of small businesses, members of faith communities, management committee members from village halls, PTA members or school Governors, organisers and members of community groups etc etc.

This is your chance to have your say

Wendy Irons
Medway Council

Follow me on Twitter:
Empower Communities @WendyMedway
Facebook Page:
Empowering Communities Medway

High Halstow Website

Please visit the Parish Council website for everything about our village. You can see the minutes of your Parish Council or look up local groups in the village, past copies of the High Halstow Times, and pictures of recent events.

Christmas Tree Festival 2014

On December 13th the Village Hall doors will be open to the third Christmas Tree Festival in High Halstow.

It is not too late to let us know if your group, family, business etc would like to put a tree in. All we are asking for is a donation of £5.00 per tree submitted.

Trees can be any size or shape, fresh or artificial; as far as decoration is concerned, the only limit is your imagination and afterwards your tree goes home with you for Christmas.

Trees can be decorated at the Hall or brought ready-decorated. Power is available for lights

Trees should be brought to the Hall on

Friday 12th December from 19.00 to 21.00 or
Saturday 13th December from 9.00 to 12.00

Trees must be collected on

Saturday 13th December from 17.00 to 19.00

Please invite all your friends to come and see your entry and enjoy this event. With your help - and with the help of others – please make this Christmas Tree Festival a success.

The public are invited to view the trees from 14.00 to 16.30 with entry being just 50p. Refreshments will be available on the day

Friends of St Margaret's Church



Friends of St Margaret's Church

It was agreed at the last meeting to fund 50% of the works in replacing the fencing at Forge Common, which has seen better days. In addition the Notice Board has had a refurbishment paid for by the Friends

There is a vacancy on the Friends Committee and any member wishing to join, in the first instance could you please contact me at gary@highhalstow.org.uk for further details

The PCC have been asked to identify a longer term project for which the Friends can target some of its fund raising activities as well as identifying smaller projects which we too can help contribute to. Once we know what this project will be, we will inform you all accordingly

Over the coming months we will running two fund raising activities with the first being the Annual Christmas Tree Festival and the second the First Cake Festival, details of both can be found in this months HHT

Our monthly subscriptions continue to rise and it should be remembered it is not too late to make a monthly donation. Details can be found at <http://thefriendsofstmargarets.org.uk/how-to-join>

Thank you for your continued support

Friends of St Margaret's

High Halstow Hikers

In October Ian Deal led us on a lovely varied autumn walk starting from Shipbourne Church.

Fifteen of us followed well-made tracks (for which we were grateful after the recent rain) to Ightham Mote which is a fantastically well-preserved medieval manor house which can be appreciated from the public footpaths. We found that the National Trust cafeteria there is also worth a visit for mid-morning refreshment. A moderate incline along the Greensands Way led us past Cinderfield, Greyberry and Elder Woods and as the woodland opened we had views south and east to May's Folly at Hadlow and of Tonbridge slightly further away. We dropped down through woods and avoided the challenge of a long muddy path across a field by skirting the edge of the field. Lunch at the Chaser Inn at the end of the walk was welcome and very good.

Our November walk will start as usual at 10.00am but will be on SATURDAY 8th to avoid clashing with Remembrance Day. We will start from the Car Park at Cliffe Church which is simple to find by following the B2000 into the centre of the village. We will do a flat marshland walk to the river bank that could well be muddy in places.

All are welcome to join the walk. Any questions please contact Mitchell on 01634-254428 or on mitch.dowsett@btopenworld.com.

Memorial Hall News

As stated in the October Times our Christmas Market will be on Sunday 30th November from 11am until 2 pm, as usual there will be Pick-a-Duck where everyone gets a prize, a table full of stocking fillers as well as a raffle and, of course, tea coffee and cakes to eat or take away.

On the following Sunday 7th December there will be a Gift Room open from 1pm to 4pm.

Mother and Toddlers who meet in the hall on Thursday mornings 9am to 11am would love to have some new members but also are in need of some new toys, so if you are making space for those being delivered by Father Christmas, and would like to donate them to Mother and Toddlers they can be dropped off at the hall on a Thursday or call Natacha on 254178 who will arrange collection.

Parish Council Consultations

Dog Bin

The Parish Council are looking to put a further dog bin in the Village this year and are asking you for your views as to where this would be best used. If you have an opinion please pass your comments on to the Parish Council

All Weather Path from Ruggles Close to the Street

In conjunction with Medway Council, the Parish Council may have an opportunity to put an All Weather Path from the entrance to the alley to Ruggles Close all the way to the Street by the Bus Stop. The plans will be discussed at the next Parish Council meeting and this is your chance to have your say

High Halstow Parish Council

Poppy Appeal

It is with regret that after almost 40 years of distributing poppies in the village, I am unfortunately having to retire.

I would therefore like to thank everyone who has helped me in raising a considerable amount of money towards this worthy cause.

***Susan Osenton
Dalham Farm***

NB. The Parish Council would like to thank Susan for all the hard work she has done over the many years for this worthwhile cause.

Resume Of The Parish Council Meeting Held On 8 October 2014

The meeting held on 8th October was attended by 7 of the 9 councillors. Chris Watson was on holiday and Stuart Bailey was away for work. It was also attended by 14 members of the public. Prior to the start of the meeting, the prize-winners for the annual photographic competition were announced and certificates presented.

High up on the agenda was the skateboard/scooter half pipe. Following concerns about noise expressed at the previous meeting, Stuart had been to see an installation by the same manufacturer at Culverstone and had reported there was little noise. The Chairman of St James Isle of Grain Parish Council had also said they had a half pipe of the same design and manufacture, although bigger and that they had not had any complaints. A final decision was taken and it will now go ahead. The half pipe is now on order, but it will be a few weeks before it will be installed and this will be weather dependent.

Quotations had been received to install a new fence at the far end of the Recreation Ground by the "horse field". It will be the same as that already surrounding the cricket pitch. There was a split vote on this as two councillors were of the opinion that the same job could be done for less money, but the proposal to go ahead with one of the quotes was carried by a majority of 5 votes to 2. As yet we do not have a date for the work to be carried out.

The blocked drain in the hall car park has been cleared but some remedial work needs doing and the same contractor will carry out the work shortly. It was suggested that the entrances to the car park are "in" and "out". This arose some years ago and it was never decided which would be the "in" and which would be the "out" with arguments being received for each of the options. Brian Williams is investigating further.

Parents at the school have been campaigning for a safer crossing between the school and the car park. An option being suggested is a raised platform to slow traffic down and consultation on this will be in the Times.

The work done on the public footpath between Ruggles Close and the Recreation Ground was discussed. Two soakaways have been installed but clearly they aren't doing the job sufficiently well. Medway's Public Rights of Way Officer is willing to install an all-weather surface similar to the all-weather path at the other side of the field. This would run the full length of the public footpath from The Street to Ruggles Close. The Parish Council would be asked to make a contribution to the cost. A decision will be taken at the next meeting.

There is ragwort on Forge Common and it is a legal requirement for landowners to deal with the problem. Concern had been expressed that the wild flower meadow might be affected, but a specialist contractor, who identifies and deals with just the ragwort has been found. The work will be over a 2-year period as the plant is a biennial.

Unusually, there were no planning applications. The other item to mention is that the audit of the Parish Council's finances and procedures for the year to 31st March 2014 has been successfully concluded.

The next meeting will be held on Wednesday 12th November at 8pm in the Memorial Hall.

Noisy Scooters/Motorbikes

A number of complaints have been made about scooters and motorbikes racing around parts of the village, particularly around early and late evening. The bikes are known to be loud and a nuisance especially when young children are being put to bed and trying to sleep. It is thought that the motorcyclists live in the village and are not passing through but riding around as fun. Please could whoever is responsible for these bikes/or are the parents of the young adults responsible for the bikes ask the riders to be more considerate to other residents in the village.

HH Parish Council

Come and Meet Your Parish Councillors

Chris(tine) Watson & Gary Jerreat, two of your Parish Councillors will be at Kings Kitchen in the Memorial Hall on: Tuesday 11th November from 10.30 – 12.00pm and every 2nd Tuesday in the month.

Come and tell us your

problems or find out about projects we are undertaking. If we can't answer your questions there and then we will get back to you.

High Halstow Parish Council



Proposed Uncontrolled Crossing

Following concerns from local parents with regard to the speed of through traffic on The Street, that poses a risk to pupils and parents during school arrival and egress, a proposal is being designed to introduce a traffic calming measure outside the school.

A traffic calming proposal has now been prepared to help limit through speeds at this location and assist pedestrian movements. It is proposed to have a raised table with a 4m crossing area for parents and pupils, near the school entrance between the entry/exit points to the surgery opposite, as shown in the drawing below.

The road safety team at Medway Council welcome our views and comments on this proposal and request that any comments be returned by 30th November 2014 at the address below or

via email to travel.safety@medway.gov.uk

Bryan Shawyer
Frontline Services
Regeneration, Community and Culture Directorate
Medway Council
Gun Wharf
Dock Road,
Chatham
Kent ME4 4TR

An electronic version of the draft drawing is available on the High Halstow website

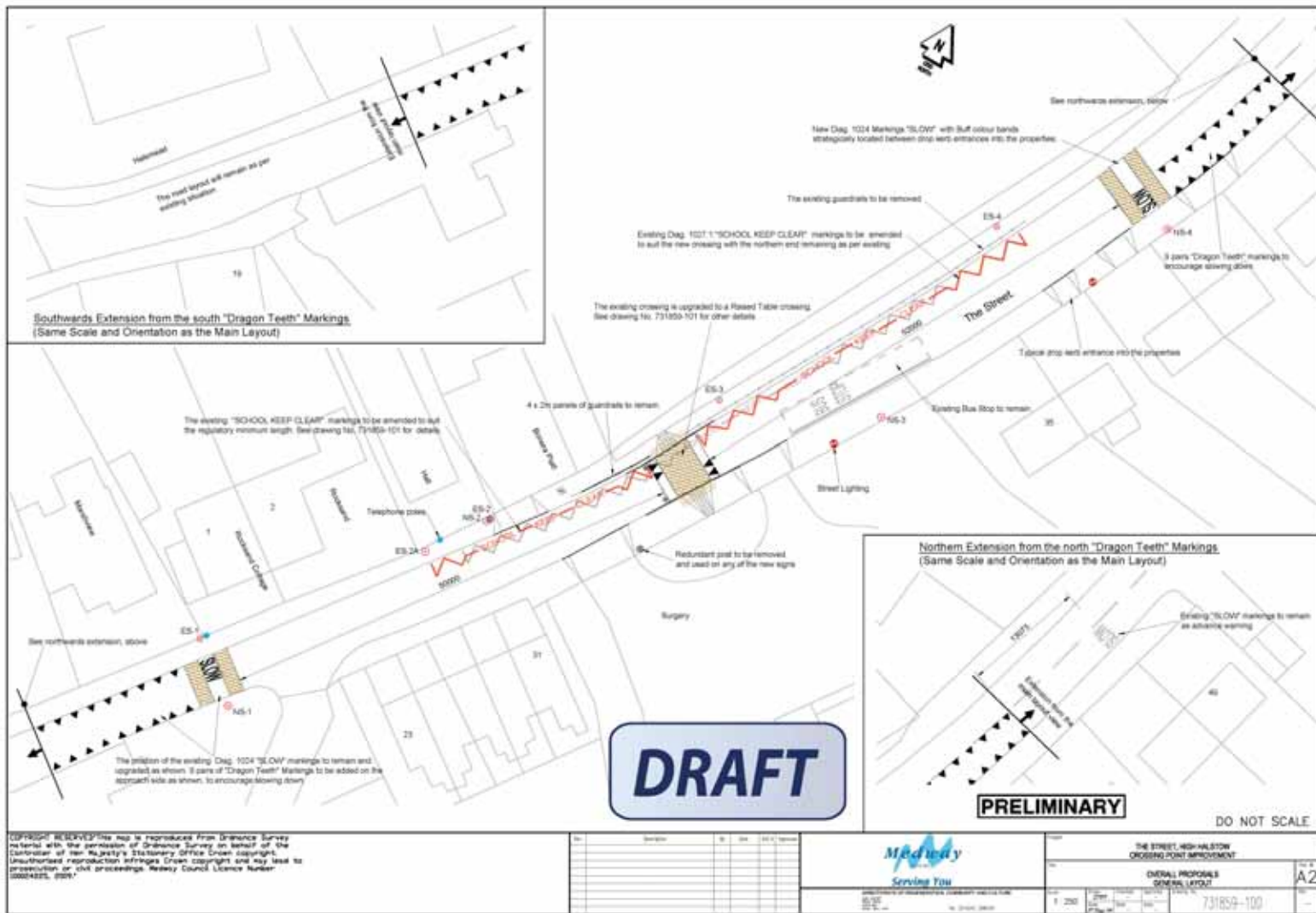

10 Facts about 5 November.

Bonfire Night rolls around again next week, but how much do you actually know about bonfires, fireworks and everything else that surrounds the event?

Here are ten facts you might not know about 5th November.

1. A firework can travel at speeds of up to 150mph, the same as some biplanes.
2. The name "bonfire" derives from the term "bone fire"; in the Middle Ages, these types of fires were usually set up in order to burn bones.
3. Up until 1959, it was illegal to NOT celebrate Bonfire Night in the UK.
4. There is at least one school in York taking advantage of the lifting of this law; St Peter's School was attended by one Guy Fawkes, and they refuse to burn his effigy as a mark of respect for their former pupil.
5. In an average year, there will be just under a thousand injuries caused by fireworks during October and November in the UK. Around half of these are children injured by fireworks or sparklers.
6. Fireworks were actually invented by accident; in the 10th century, a Chinese cook accidentally mixed three common cooking ingredients (sulphur, charcoal and a salt substitute) and set it alight, which resulted in very colourful flames.
7. Fireworks first reached Europe in the 14th century, and were initially produced by the Italians; the first recorded display took place in Florence.
7. The first recorded fireworks display in England was at the wedding of Henry VII in 1486.
9. Had Guy Fawkes managed to light the 2500kg of gunpowder underneath the Houses of Parliament, he would've caused damage within a radius of almost 500 metres.
10. Calls to fire services across Britain can almost triple during Bonfire Night. Be sure to stay safe!

The Firework Code

- Light sparklers one at a time and wear gloves
- Never give sparklers to a child under 5 years old
- Buy fireworks marked *BS 7114*
- Keep fireworks in a closed box
- Follow the instructions on each firework
- Light them at arm's length, using a taper
- Stand well back
- Never go back to a lit firework
- Never put fireworks in your pocket
- Never throw fireworks
- Keep pets indoors.

Hoo Village Institute
25 Main Road, Hoo ME3 9AA

In aid of
Anim-Mates
Animal Rescue Sanctuary



Admission £2

Our Annual
Fun Auction
of unwanted gifts, presents,
knick knacks, lots of fun items, etc

Sunday 16 November at 7.30pm

Contact 01634 271262 for further details



Toddler Group

Come and join us for a cake & a coffee while the toddlers play!

A great way for Mums & Kids to make new friends.

Babies to 4 year olds, just £1 for two hours of play.

Every Thursday, 9am to 11am at the Memorial Hall, High Halstow.

For more details, call Natacha on 254178

Your first session is FREE!

High Halstow 2014 Photographic Competition

Wow!! What a competition this year, record number of entrants , record number of photographs.
Winners this year are as follows:

Overall Winner

Sarah Harrison – Sleepy Dog



Under 18's

1 st Place	Sarah Harrison	– Sleepy Dog
2 nd Place	Anoushka Smith	– Blackberries
3 rd Place	Lilly O'Sullivan	– Single Flower

People & Places

1 st Place	Steve Hare	– Sunset
2 nd Place	Trevor Peek	– Youth Club
3 rd Place	Hugh Russell	– Cricket

Flora & Fauna

1 st Place	John Pink	– Humphrey in the Snow
2 nd Place	Sarah Axell	– Hedgehog on the Lawn
3 rd Place	Peter Collins	– Toady

Highly Commended

Zoe Bailey, Jessica Durrant, Stephen Gwilt, Luci O'Sullivan

As usual a calendar will be produced with the proceeds going towards the Village Hall Refurbishment programme. They will be on sale in the shop from 1st November £6.50 large, £5.50 small. Thank you all to the people who entered this years completion, roll on next year!



Local girl needs votes to help her become Miss England



Amber, 17, is currently one of 30 contestants competing in the first Miss England semi final heat for 2015. Amber has always lived on the Peninsula and has both sets of grandparents living in High Halstow.

The public vote is now well underway and she needs the support of her local community before voting lines close in order to secure a top 3 place in the heat.

The winner of this heat will go on to compete in the Miss England 2015 semi-final, where she will be in with the chance of securing a place in the grand final next year. The ultimate winner of Miss England 2015 will spend her year raising awareness for various charities and will receive a whole host of prizes worth £30,000, including a luxury holiday to Mauritius the dream holiday destination and a place in Miss World 2015.

In the last three years over £550,000 has been raised by Miss England contestants to help disadvantaged children around the UK.

You can vote for Amber by texting MISS ENGH16 to 63333 or vote from a landline, which is: 0901 3078571 and press 16 when prompted.

Text votes costs 50p whilst Landline votes cost 52p plus standard network charge. Please get permission from the bill payer before voting.

The voting line opened FRIDAY 3RD OCTOBER AT 5PM and will finish on SUNDAY 30TH NOVEMBER 2014 AT 12 MIDNIGHT.

Good luck Amber.



High Halstow Also-Quilting Sewing Bees



Never Sewn Before??

Only Sewn a Bit??

Want Something New??

Then this is for you..

Patchwork & Quilting

All you need to bring is
a pillowcase, some pins
and yourself.

Come and have some fun,
we'll have you in stitches.



Trial Sessions only £3

Wednesday's 5th, 12th & 19th September
12noon - 2pm

High Halstow Memorial Hall
(First 3 Wednesday's of each month)

More Information

Please feel free to call
Cheryl on 01634 255758

High Halstow Relief in Need Charity

This charity exists to assist those in the Village who are in need, especially widows and widowers. The trustees wish to remind the people of the parish that they will give consideration to any request for a particular need, at any time during the year. If you, or an elderly relative would feel safer at home with a telephone 'Lifeline' the Charity could help with this. All requests are dealt with in complete confidence and there is no need to wait for the October form.

The trustees are:

- Rev. S. Gwilt - The Rectory
- Mrs L. Munday - 22 Willowbank Drive
- Mr S. Bailey - 27 Cooling Road
- Mrs J. Gillies - 22 Leaman Close
- Mr J. Myatt - Decoy Hill Road
- Mrs C. Peek - 2 Willowbank Drive
- Mrs J. Collins - 6 Marsh Crescent

Woodland Management – Northward Hill

The RSPB owns Northward Hill, and the nature reserve is one of the oldest in the charity's history. The nature reserve comprises a variety of habitats, the majority of which is lowland wet grassland (grazing marsh), but we also have pools, scrubland and woodland. The nature reserve is managed for biodiversity and this is achieved through a corresponding variety of land management. Most of the reserve is a working farm, and the livestock, while providing wool and beef, are a vital component for breeding and wintering birds. We allow access to 10% of the reserve so that people can connect with nature; this is one of the RSPB's charitable objectives. Most of the woodland is a sanctuary area for breeding birds because evidence shows that dogs displace nesting for a wide area alongside paths because most small woodland birds nest quite close to the ground, particularly nightingales. That said, a good proportion of the wood has open paths that provide great walks connecting High Halstow village with the reserve and the unique vista across the marshes to London and Essex.

As a responsible landowner that has public access to our nature reserves we have to ensure that our trails are as safe as possible, we have to ensure that our trees are healthy and not a danger to the public. In the main this is about trees along nature trails that are assessed as having the potential to cause harm. This doesn't necessarily mean trees that are away from the nature trails where we are quite happy for them to become more 'dangerous' in a managed way, because dead and dying trees have a huge amount of benefit for woodland invertebrates, especially beetles.



Trees have a lifespan, albeit a long one, but they come to an end eventually and we have to act where trees show indications of becoming a danger. We are regularly inspected by an independent tree safety advisor who will mark those trees identified as potential dangers. Trees that are marked are monitored for further signs of deterioration. If the trees deteriorate further we have to lop branches or fell them.

You may feel that removing what are lovely trees is extreme, but as autumn gales return we have already seen in the news this year fatalities due to falling timber. We do not want visitors to suffer injuries whilst enjoying their time on our reserves and we must also ensure there is no cause for people to bring a claim against us, especially spurious claims, because that is poor stewardship of our members' money.

Due to the loss of woodlands across the UK, and most particularly in Medway (as documented by the Dickens' Countryside Protection Society), the natural processes that would have kept our woodlands healthy for a broad diversity of nature no-longer function in the small pockets of trees that are left, therefore man has to actively manage woods to keep them in good shape. In the past, lightning strike and storms would have brought large trees to the ground creating natural glades and native herbivores would also have kept growth in check.



Northward Hill is too small to experience nature's natural influences upon a forest so, in the interests of the wildlife we still do have, we undertake management that replicates these processes. We have an annual programme of coppicing and felling of small areas. All forestry work follows the reserve management plan, produced in consultation with regional and national RSPB woodland ecologists and with Natural England, the statutory body governing the management of Sites of Special Scientific Interest such as this.

What does the management entail and how is it good for nature? We have been removing sycamores, which are a non-native species that



supports less wildlife than native species. We also thin-out oaks, which become skinny and rank if too densely packed and this permits the remaining oaks to broaden into mature trees that support more life, in particular colonies of the purple hairstreak butterfly. Felling selected trees and widening the rides lets sunlight in and this stimulates the growth of a greater variety of woodland shrubs, nettles, and flowers like dog violets, primroses and yellow archangel. This is habitat for an assemblage of invertebrates: caterpillars, butterflies, bees, moths and dragonflies. Butterflies need the direct warmth of the sun and we now see the spectacular silver-washed fritillary and white-letter hairstreaks in the glades, we hope to attract back the white admiral. This vegetation management and the invertebrate

food for birds is crucial for three bird species in particular that have very strict requirements when it comes to trees: Nightingales, turtle doves and cuckoos, all of which are suffering serious population crashes in the UK. Nightingales will use regenerating scrub (small trees) of an age between 2-8 years old, whilst turtle doves use an age range of 7-14 years old. By selectively coppicing and felling trees on a 14-year cycle we provide the precise conditions for these breeding birds. Over the last couple of years our nightingales have increased to 29 pairs in and around the wood - the highest that this has ever been. Unfortunately, our turtle doves are not faring so well and have dwindled to one pair last year. We believe that this is a result of the decline in the wider countryside and problems that they experience on migration. However, we will continue to do what we can for this species including the sowing of special seed crops on the reserve (near the view point). Cuckoos



feed on hairy caterpillars such as red admirals and small tortoise shells, the rides and glades support this important food source and we had six calling cuckoos at Northward Hill this year! The focus on woodland management has also brought back at least one pair of breeding treecreepers and lesser-spotted woodpeckers after an absence of decades, so there is strong evidence that our management is, on the whole, working.

The undesirable effects of woodland management for visitors are short-term, the work can be noisy and it can look harsh until the vegetation returns in the spring, the benefits however are great and varied. The firewood we gather is good quality and its sale to the public supports the management. Most of the work is undertaken by volunteers and at Northward Hill we run a one-year internship programme. Interns live in the farmhouse and the RSPB pays for their training to achieve national certifications in the use of chainsaws, brush-cutters, quad bikes and tractors. In the last two years nine have gone straight into full-time warden jobs including RSPB The Blean, Rainham Marshes, and the Dee Estuary. Otherwise our volunteers are from the local community, and work each Thursday with the wardens on site. If you would like to join the team as a volunteer helping to keep RSPB Northward Hill a truly special place for nature, please contact the warden (01634 222480).

Share your Thoughts, Ideas and Comments.

Do you have a story about the history of the Village, did you go to or know anything about the old school, can you tell us a story about a picture in the Memorial Hall? Would you like to promote an event or club within the village. Is there something concerning High Halstow that you would like to share with everyone. Then please write to the editor (address as shown on the back page) or e.mail your article/letter and we will share your thoughts with the village/world.

***Friends of St Margaret's Church
Proud to Present
Cake Festival***

***Village Hall
1st March 2015***

The Friends are pleased to announce the very first Cake Festival within the Village.

There will be a competition for the following categories

- 1 Cup Cake Challenge
- 2 Fruit Cake
- 3 Chocolate
- 4 Bible Cake
- 5 Novelty
- 6 Celebration
- 7 Gateaux

Entry fee will be £3.00 for the first category you wish to enter followed by £1.00 per additional category you wish to enter. For example if you enter the Cup Cake (six cup cakes) plus the Celebration and Gateau, the entry fee will be £5.00.

We are working on the rules and these will be published next time and on the website
<http://thefriendsofstmargarets.org.uk/>

Quizathon

Another great evening organised by the Quiz Team saw a further £215 raised towards the Hall Refurbishment Programme. This event raises a £1000 during the year and is very much appreciated by the Village Hall Committee

This was the fourth Quiz Night of the Year and is becoming a regular feature within the Village. Many thanks to Margaret, John and Lesley who run this event

Thanks to all who came along to support and hope to see you again next year

Village Hall Committee

Responsible Parking

It has been noticed that a number of vehicles around the village are either parking on the kerbs, causing obstruction to pedestrians and risking children crossing the road unseen between parked cars; or are parking on corners which is a danger to other road users. Please park with consideration to pedestrians and other road users.



***Your personal invitation
to celebrate Christmas***

14th December
11:00am DIY Nativity service (Allhallows)
6:30pm: Carol Service (Allhallows)

21st December
6:30pm: Carol Service (High Halstow)

24th December
**5:00-6:00pm Messy Christmas for children
followed by a visit from Santa (High Halstow)**
11:30 Midnight Communion (High Halstow)

25th December
8:00am Holy Communion (High Halstow)
9:00am Christmas family service (High Halstow)
10:30am Christmas family service (Allhallows)

**For more information please contact Rev Stephen Gwilt on
01634 250637 or Stephengwilt2@hotmail.co.uk**

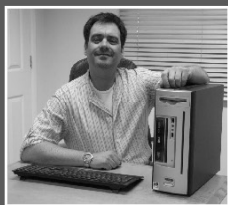

Jonathan Computers

Contact Jonathan directly on the Office No: 01474 879878 or

Freephone: 0800 321 38 79

Email: sales@jonathancomputers.co.uk



REALLY IMPORTANT!!!!



Does this look familiar???

Does your COMPUTER run....



Currently from 8th April 2014*

Microsoft™ Support

for ALL XP™ Versions will discontinue!!!!

YOUR COMPUTER WILL BE AT SEVERE RISK!!!!

I Can upgrade or supply new computers with...**

- ☐ Windows™ 7 on.... and **NOT** the new unpopular Windows 8™ on!

* As currently stated by Microsoft™ as at 1st December 2013. **Subject to Old PC Specification.

You may become vulnerable to:

- ☐ Destructive Viruses!
- ☐ Banking Fraud!
- ☐ Total Computer Failure!
- ☐ On-Line Credit Card Theft!
- ☐ Identity Stolen!
- ☐ Being Spied On!

(All Antivirus products will cease to update at this time also)

If Running XP you will need to upgrade or replace your old PC To keep yourself Secure!!!**

I Am Based In High Halstow So Can Be Quick To Respond

I will deal with you personally so I can provide you with the best service. I offer a fast and friendly service and explain any problems about your computer to you in an easy to understand way.

*Regards
Jonathan*



HUBBARD INTERNATIONAL
with
The Parish of All Saints, Allhallows
Present



Christine Hubbard

International Soprano

with

**Kenneth McCarthy, tenor &
Peter Wilson, piano**

In

**Winter
Warmers**

15th November 2014 at 7.30

In

**All Saints Church, Stoke Road
Allhallows ME3 9PH**

**Tickets £8.00. Available from 07702 371428
or on the door.**

Refreshments will be available

Sparkling Serenity Beauty

Massage
Spray Tanning
Bio Sculpture Gel Nails
Manicure & Pedicure
Callus Peels
Eyelash Extensions
Threading
Waxing
IPL Hair Removal
Shrinking Violet Body Wraps
Facials and Facial Peels
Eyelash Perm/Lift

*Keep up to date with
treatments & offers*

*Based in High Halstow
Contact Jade 07708394979
www.sparklingserenity.co.uk*



Take Care

... Supporting your Independence



Home Help Service

Are you ...

- An older person?
- Living with a disability?
- Having difficulty with day-to-day tasks in your home due to ill health?
- Convalescing?

We can help you with ...

- Housework ■ Laundry/Ironing ■ Shopping ■ Support to the shops and appointments ■ Respite sitting service ■ Companionship for outings and community activities ■ Handyman/Gardener service

Our Community Assistants are carefully chosen and matched to you. We believe that having the same face is important for continuity and your wellbeing - CRB checked, fully insured and referenced.

www.take-care-ltd.co.uk



01634 316821

LOCAL ELECTRICIAN

Domestic + Commercial + Industrial
NAPIT PART P APPROVED ELECTRICIAN
Steve Waldie

Full & Part Rewires - Consumer unit changes - internal power sockets & lighting - External power & lighting - Bathroom fans - Testing & inspection - Alarm Systems

No Job Too Small - No Call Out Charge
All work fully insured and guaranteed



Tel 01634 253169 Mob 07833 251805

Need to Hire a Hall

If you are interested in hiring either of the halls in the village for a party, function or meeting please contact:

Memorial Hall - Angela Forward 251756

Village Hall - Crystal Wakefield 251849

Please do not call on a Sunday.

Kings Kitchen

A Coffee and Cake Café
 for the Whole Village.

Open 10.00am - 1.00pm
 every Tuesday
 in the Memorial Hall.

Why not come in and enjoy a cuppa and a chat.

A warm welcome awaits you.



High Halstow Pre-school

Modular Building, Primary School, Harrison Drive,
 High Halstow, Rochester, Kent. ME3 8TF
 01634 255088

Proprietor/Manager Mrs Anita Russell BA (Hons), EYPS

- ✓ 'Outstanding Provider' Ofsted
- ✓ 2009-10 Extensive Outdoor Facilities
- ✓ Excellent Links with Primary School
- ✓ Friendly, Qualified Staff
- ✓ Affordable Childcare

Open Weekdays, term time only
 8.45 am - 3.30pm

Morning, lunch, afternoon and all day sessions available.

Children are funded for 5 free sessions the term following their third birthday.

Don't take Ofsted's word that we are an outstanding provider, come and see for yourself.

Ring 01634 255088



Rochester Roofing

RE-ROOFING • REPAIRS
CHIMNEY WORK • LEAD WORK
SOFFITS & GUTTERING • TILING

Friendly reliable service, free inspection - fully insured

Contact Paul on: 07903 581926
 paul@rochester-roofing.co.uk

Village Hall

Auction

Apologies to all for the short notice in the cancellation of the above event. Rest assured the event will go ahead in the New Year so please watch this space for further details

Village Hall Refurbishment Update

As you know we are on Phase Three, which is planned for the new kitchen, new stairs, new main entrance and bar area. We have met with the architects and agreed a proposal for which the architects are drawing up the plans.

These will be available for viewing as soon as possible as we would your comments on the proposals so please watch this space.

Village Hall Committee

Speed Limits

Please can I remind people to observe the speed limits through the Village. We should all be mindful that High Halstow

is a nice place to live where children, older residents and walkers should feel safe. Some may not be as aware of the traffic as they might otherwise be. Please be careful.

George Crozer, HH Parish Council



Your Parish Councillors

George Crozer, Chair 01634 250286
e.mail: george@highhalstow.org.uk
Gary Thomas, Vice Chair 01634 252812
e.mail: gary@highhalstow.org.uk
Martin Andrews 07984 791029
Stuart Bailey 01634 255537
Ray Collins 01634 250105
Gary Jerreat 01634 253999
Lesley Munday 01634 250276
Christine Watson 01634 256529
Brian Williams 07908 006448
e.mail: bdwilliams9@hotmail.com

Your councillors may also be contacted through the Parish Clerk:

Mrs Roxana Brammer 01474 871269
clerk@highhalstow.org.uk

Sunday Services

8:00am High Halstow

Holy Communion BCP

9:30am High Halstow

1st and 3rd Sundays All age worship

2nd and 5th Sundays morning prayer

4th Sunday Family Communion

6:30pm High Halstow

1st Sunday Holy Communion

3rd Sunday Informal worship

5th Sunday Joint Songs of Praise with Allhallows

See notice board for venue

Baptisms by arrangement

1st or 3rd Sunday of each month at 9:30am

For further information. Rev Stephen Gwilt 01634 250637

Or Email stephengwilt2@hotmail.co.uk

Caring for the needs of the community for over 1000 years

Let us not give up meeting together, as some are in the habit of doing, but let us encourage one another - and all the more as you see the day of judgment approaching. Heb 10:25



HOME IMPROVEMENTS

ALL NEW RESIN BOUND SYSTEM



TOTALLY WEED FREE - CAN BE LAID OVER EXISTING SURFACES LIKE TARMAC & CONCRETE - 15 YEAR GUARANTEE -
MAINTENANCE FREE - NON SLIP SURFACE - CHEAPER THAN BLOCK PAVING - SUITABLE FOR DRIVEWAYS, PATHS & PATIOS,
ALSO SUITABLE FOR WET ROOMS FLOORS & WALLS, BATHROOMS, KITCHENS & SWIMMING POOL SURROUNDS
WIDE VARIETY OF COLOURS AVAILABLE, TOTALLY UV PERMEABLE WHERE REQUIRED AND SUDS COMPLIANT

CALL 07921 838813 OR 09721 842395

ENQUIRIES@CONCEPTBUILDER.CO.UK - WWW.CONCEPTBUILDER.CO.UK



Part of TRADE INFORMATION LTD

Dates for Diary

Every Tuesday:

King's Kitchen

10:00

Memorial Hall

Bell Ringers

19:30

St Margaret's

Church

Every Thursday:

Mother and Toddler's

09.00

Memorial Hall

Sugar Babes

19.00

Memorial Hall

Every Friday:

Pilates with Joy

14:15

Memorial Hall

Every Saturday:

Karmann Dancers

09.00

Memorial Hall

Every 4th Wednesday:

Friendly Club

Memorial Hall

Other Dates:

Sunday 2nd:

09:00

Family Service

St. Margaret's Church

Wednesday 4th:

19:30

Women's Institute

Memorial Hall

Thursday 6th:

10:00

Empowering Communities
on Hoo Peninsula

Saturday 8th:

High Halstow Hikers

Details in HHT

Sunday 9th:

8:00am & 10:15

Remembrance

Service

St. Margaret's Church

Tuesday 11th:

20:00

Gardening Club

Memorial Hall

Wednesday 12th:

20:00

Parish Council

Memorial Hall

Sunday 16th:

09:00

Family Service

St. Margaret's Church

Saturday 22nd:

12:00

Taste of Christmas

Village Hall

Friday 28th:

20:00

Quiz Night

Memorial Hall

Local groups, please let us know the dates of your meetings/events for the coming year so we can include them in the HHT and on the website.

Dramarama

We will be performing Robinson Crusoe & The Pirates on Thursday 29th, Friday 30th, Saturday 31st January 2015. Tickets will be going on sale soon. Please keep the date free and support our group.

Learn GUITAR

Professional guitarist and guitar teacher offers 1 to 1 tuition. All ages and abilities welcome. Graduate of London Guitar Institute and playing experience includes The Who and Robbie Williams. Can inc practical, grades & theory.

CHRISTMAS VOUCHERS AND DEALS AVAILABLE
HOME VISITS OR AT HOME STUDIO IN CHRISTMAS LANE

Call Matthew 07967 125091



GUITAR LESSONS
07967 125091

GUITAR LESSONS
07967 125091

GUITAR LESSONS
07967 125091

GUITAR LESSONS
07967 125091

GUITAR LESSONS
07967 125091

GUITAR LESSONS
07967 125091

GUITAR LESSONS
07967 125091

GUITAR LESSONS
07967 125091

GUITAR LESSONS
07967 125091

GUITAR LESSONS
07967 125091

Divine Party Cakes

Cupcakes, large cakes & cupcake
decorating parties

www.divinepartycakes.com

Find Divine Party Cakes on Facebook!

e-mail: info@divinepartycakes.com

Sadie 01233 501832
Sephie 01634 254175



PAUL HUGHES

Double Glazing Repairs

NO CALL OUT CHARGE FREE ESTIMATES



- Misted Units Replaced
- Cracked Units Replaced
- Broken Hinges
- Cat Flaps Fitted
- Locks Repaired
- Damaged Handles
- Doors Re-Adjusted
- Windows Fitted

M: 07815 948637
H: 01634 256631



*The Parish of High Halstow and Allhallows
with St Mary Hoo are delighted to present*

A TASTE OF CHRISTMAS

SATURDAY 22nd NOVEMBER 2014

12.00 - 3.00 p.m.

**at the HIGH HALSTOW
RECREATION HALL**

*Locally made preserves, cordials,
crafts, cakes and festive food*

Beautiful hand-crafted Christmas decorations, books

Dress up in the Festive Photo booth

Design your own Christmas bauble

And a whole lot more.

*With a special guest from the North Pole
as well as children's games and stalls*

**Come and join us for lunch. There will be a
selection of hot and cold food available
and get ready for the best Christmas ever**

Readers Letters

Dear HHT,

We went on holiday between the 9th and 30th August and left my wife's car on the drive full of diesel. When we returned the car had been fully drained of fuel. Luckily they had not damaged the car but it has now prompted me to install CCTV aiming at the cars on our drive at a cost of £375. I have reported this to the Police.

W. Curtis
Drayton Close

Dear HHT,

Please would drivers consider carefully where they are parking when visiting the Village Shop. Some residents are parking across my drive in order to go into the shop and this is causing great inconvenience. My husband is disabled and has carers attending several times a day, plus other health care professionals. Our GP got blocked in the other day which made him late for his surgery. One of the carers damaged a wing mirror trying to squeeze out from the drive because of inconsiderate parking. There is a dropped curb plus a solid white line across the drive. The shop is very busy at certain times during the day and a great number of customers use their cars. Besides there are the suppliers vehicles as well that need to park as near as possible. People I have approached say they have only been a few minutes, but I have been in the shop myself and have had to wait nearly ten minutes to be served at very busy times. My husband and I have only been living in High Halstow for 6 months and I don't want to cause any bad feeling, but I would appreciate a level of courtesy and consideration from the villagers over where they park their cars.

Mrs Roberts
Christmas Lane

Allotments

As you may be aware the Parish Council have a number of allotments which are rented out each year. There are currently people on the waiting list, however, if you would like to be added to the waiting list please contact Chris Watson on 256529 or email me at chris.watson123@btinternet.com.

HH Parish Council

Lest We Forget

Services of Remembrance

Sunday 9th November 2014

St. Margarets Church High Halstow
8:00am & 10:15am

All Saints Church, Allhallows
10:45am

Trevor Peek

Chris and Vicki Peek would like to thank everyone for all their kindness and for the cards, phone calls, emails and visits over the last few months, during Trev's illness and since his death.

It has been a great comfort to us to know that so many people care and are there to support us.

Thank you

Chris and Vicki Peek

Well Known Carer Available to Help

Would you like some assistance around the house or with your shopping. Maybe you need someone to attend appointments with you.

I am a qualified care assistant who has worked with many people in the village for over 12 years.

If you would like to discuss your needs please contact Claire on 07890 551974 or 01634 270993

The Village Shop

Opening Hours

Monday – Saturday 7am – 8pm

Sunday 8am – 5pm

Telephone number: 01634 254561

Next edition December 2014; Contributions for December should be sent by 24th November to:

Carl Mitchell, 8 Marsh Crescent, High Halstow ME3 8TJ
or e.mail to editor@highhalstow.org.uk