

NOTES

ASBESTOS:
Contractor is to refer to the Type 3 ASBESTOS survey report and adhere to HSE guidance for Asbestos removal.

Note: Chrysolite ASBESTOS is present in the Vinyl floor. External Damp Proof Course in the Kitchen Sink draining board and Condensation pad. Removal of these items to HSE guidance.

Chipboard inside the Existing Doctors Surgery has to be surveyed for ASBESTOS.

KEY

EXISTING FLOOR FINISHES KEY

- Existing Vinyl floor
- Existing Ceramic tiles
- Existing Timber floor in the Area room to be retained
- Existing Timber floor in the First floor to be retained
- Existing Timber floor in the Area room to be retained
- Existing Timber floor in the Area room to be retained

EXISTING CEILING FINISHES KEY

- Existing Lay-in Grid ceiling tiles
- Existing Gypsum ceiling in the First floor

- DOOR, DOOR FRAME & ARCHITRAVE TO BE CAREFULLY REMOVED.
 - WINDOW, WINDOW FRAME, SILL, GILL AND BOARD UP TO BE CAREFULLY REMOVED.
 - HATCH, HATCH FRAME & ARCHITRAVE TO BE CAREFULLY REMOVED.
- CROSS REFER TO THE ARCHITECT'S SPECIFICATIONS AND DETAILS.

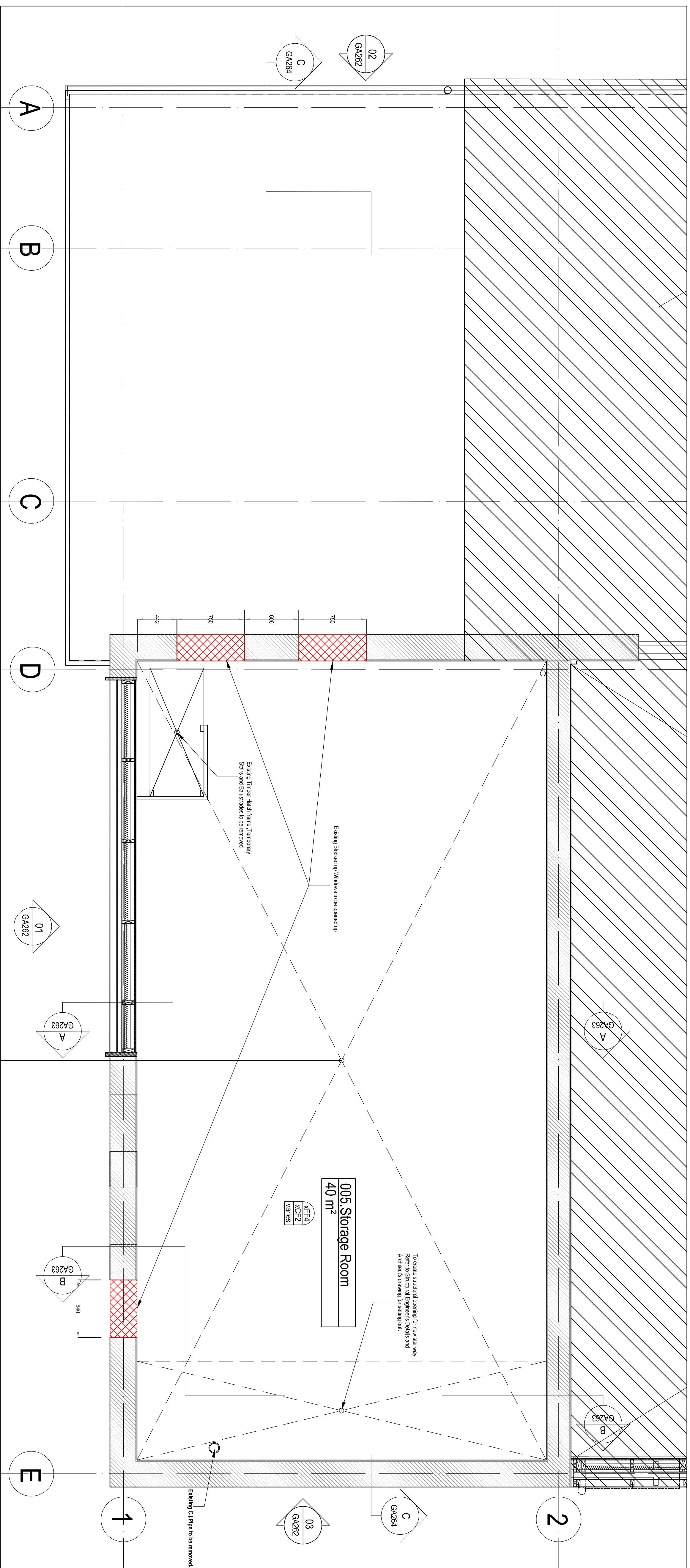

1 Existing First Floor Plan
GA 261 125

005 Storage Room	
FLOOR:	<ul style="list-style-type: none"> Create structural opening for new stairway to setting out. Existing Timber flooring FF1 to be retained and protected during building works.
CEILING:	<ul style="list-style-type: none"> Existing Ceiling Tiles - XC2 to be retained. Existing Light Fixtures to be retained.
WALL:	<ul style="list-style-type: none"> Existing Backed up windows to be opened up.
M & E:	<ul style="list-style-type: none"> Timber and masonry all in good condition. All electrical wiring & fittings serving Phase 3 area to be removed or relocated as per the M&E Engineer's design & specifications.
FINISHES:	<ul style="list-style-type: none"> Existing Timber Head frame - Sills and Balustrades to be removed. Existing Chipboard ceiling to be removed.

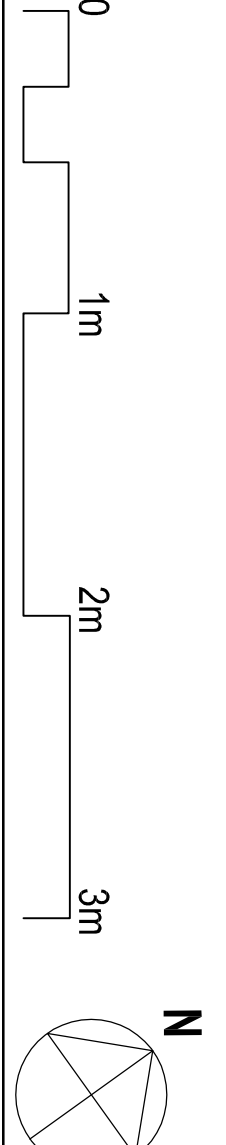

- INDICATES THE EXISTING WALLS TO BE RETAINED
 - INDICATES THE WALLS FOR DEMOLITION WORKS
 - HATCH INDICATES AREAS OUT OF SCOPE CONTRACT & IN OCCUPATION BY CLIENT THROUGHOUT DEMOLITION & CONSTRUCTION WORKS
- NOTE: EXTERIOR BRICK WORK TO BE REMOVED, GIBBS LAM AND STORED FOR REUSING.

Any deviations from drawings please contact Architect

FOR TENDER
ISSUE DATE: 17/02/15

Rev: _____ Date: _____ By: _____

This drawing is copyright. All dimensions are to be verified by the contractor before commencing work.

Project: **High Halstow Village Hall - Phase 3**
Infills and Alterations

Gray Architecture Ltd
Ground Floor, Sharnock, Watlington Road, NET 24B
Tel: 01524 571 574 Fax: 01524 571 574
Email: design@grayarchitects.com

The Scale: 1:25
General Arrangement Date: 17/02/2015
Existing First Floor Plan Drawn: SR
Drawing No: Revision: 00
5071/GA/261