

NOTES

ASBESTOS:
Contractor is to refer to the Type 3 ASBESTOS survey report and adhere to HSE guidance for Asbestos removal.

Note: Chrysolite ASBESTOS is present in the Vinyl floor, External Damp Proof Course, in the Kitchen Sink draining board and Condensation pad. Removal of these items to HSE guidance.

Capboard inside the Existing Doctors Surgery has to be surveyed for ASBESTOS.

KEY

EXISTING FLOOR FINISHES KEY

- Existing vinyl floor
- Existing Ceramic tiles
- Existing Timber floor in the Aisle room to be retained
- Existing Timber floor in the First floor to be retained
- Existing Timber floor in the Aisle room to be retained
- Existing Timber floor in the First floor to be retained

EXISTING CEILING FINISHES KEY

- Existing spray on old ceiling tiles
- Existing gypsum ceiling in the First floor

- DOOR DOOR FRAME & ARCHITRAVE TO BE CAREFULLY REMOVED.
 - WINDOW WINDOW FRAME, CILL, SILL AND BOARD UP TO BE CAREFULLY REMOVED.
 - HATCH HATCH FRAME & ARCHITRAVE TO BE CAREFULLY REMOVED.
- GROSS REFER TO THE ARCHITECT'S SPECIFICATIONS AND DETAILS.

- INDICATES THE EXISTING WALLS TO BE RETAINED
- INDICATES THE WALLS FOR DEMOLITION WORKS

HATCH DENOTES AREA BOTH OUTSIDE CONTRACT & IN OCCUPATION BY CLIENT THROUGHOUT DEMOLITION & CONSTRUCTION WORKS

NOTE: EXTERIOR BRICKWORK TO BE REMOVED CAREFULLY AND STORED FOR REUSING.

Any deviations from drawings please contact Architect

FOR TENDER
ISSUE DATE: 17/02/15

The drawing is complete.
All dimensions are to be verified by the contractor before commencing work.

Project: High Halsow Village Hall - Phase 3
Infills and Alterations

Clay Architecture Ltd
Great Lines Studio, Marlborough Road HE7 7RH
Tel: 01634 573 017 Fax: 01634 573 374
info@clayarchitects.com

Title: General Arrangement
Drawing No: 5071/GA/264
Scale: 1:20
Date: 17/02/2015
Drawing No: 00
Revision: Approved

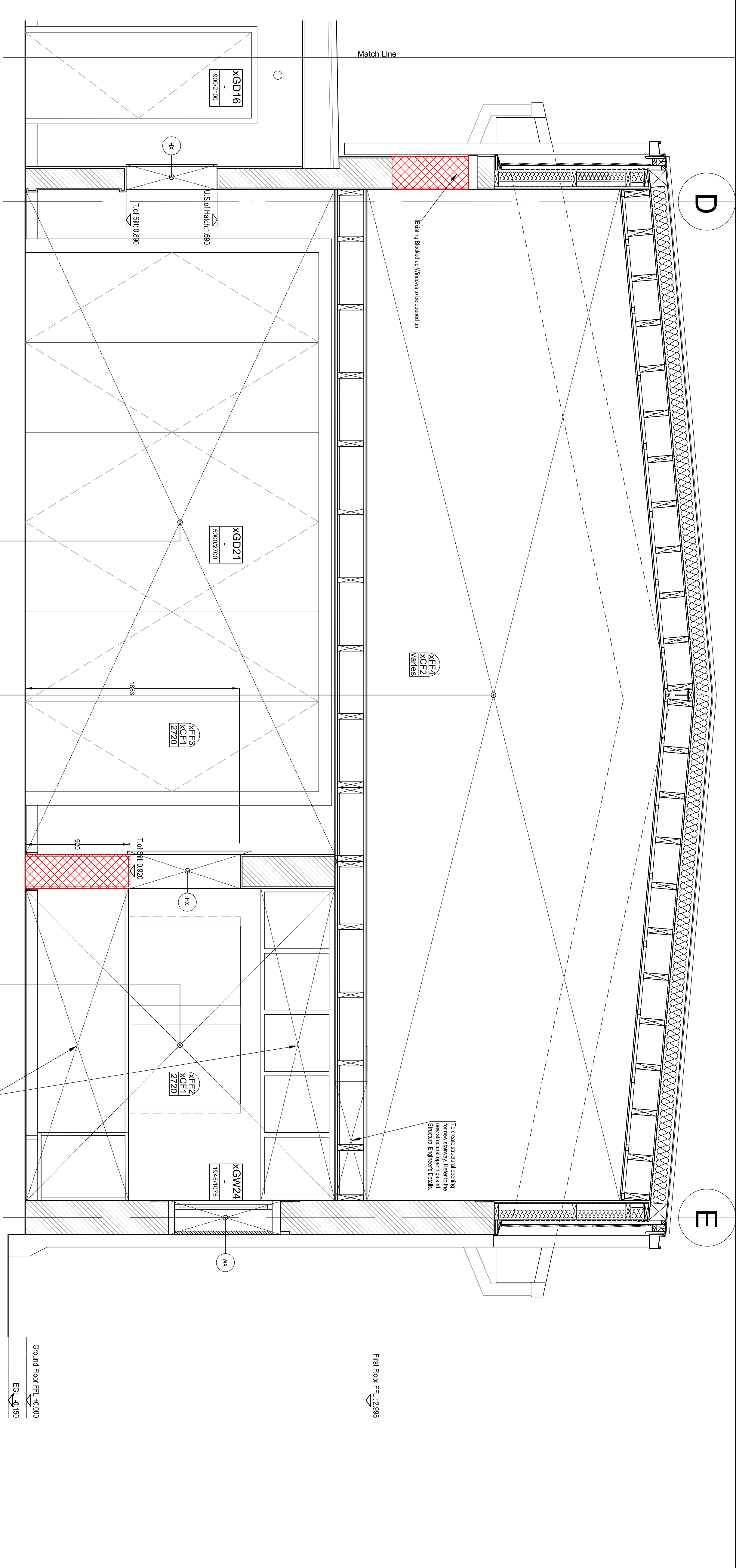

1 Existing Section C-C - Through Room nos 002,005 and 003
GA264 1:20

- 002: Aisle Room of Main Hall**
Refer to the drawing GA260 for notes.
- 005: Storage Room**
Refer to the drawing GA261 for notes.
- 003: Kitchen with Store**
Refer to the drawing GA260 for notes.

Existing Kitchen counters and Overheads, Sink, Drain board and Store equipment to be demolished. Chrysolite is present in the above mentioned items and to be removed in compliance with HSE guidelines.

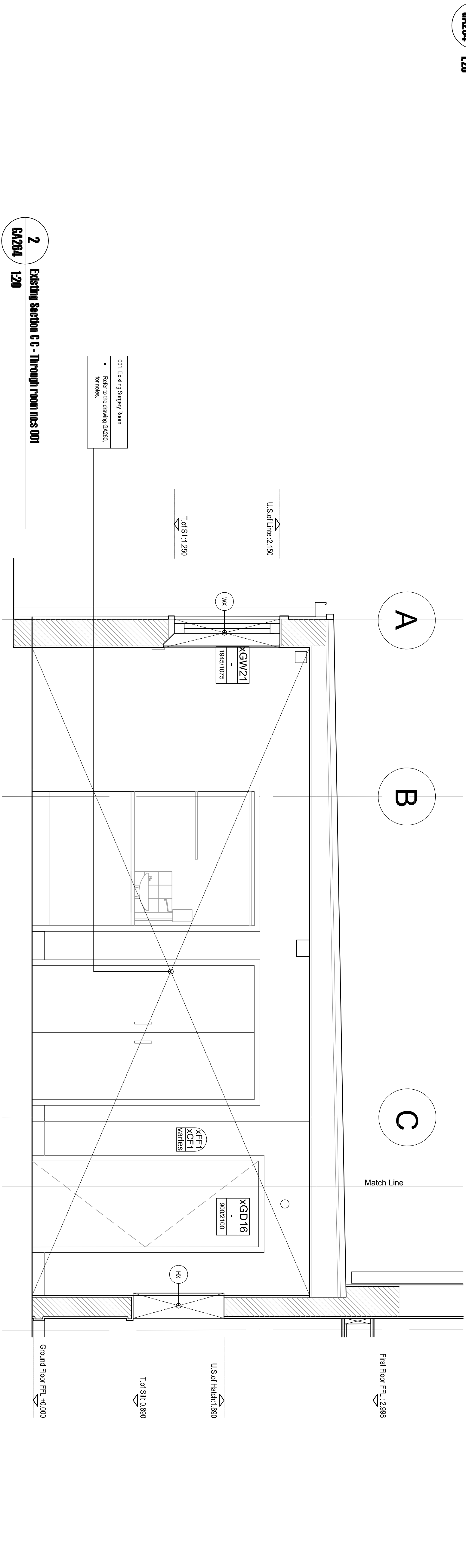

2 Existing Section C-C - Through room nos 001
GA264 1:20

- 001: Existing Storage Room**
Refer to the drawing GA260 for notes.

Existing Kitchen counters and Overheads, Sink, Drain board and Store equipment to be demolished. Chrysolite is present in the above mentioned items and to be removed in compliance with HSE guidelines.