

NOTES

**ASBESTOS:**  
Contractor is to refer to the Type 3 ASBESTOS survey report and adhere to HSE guidance for Asbestos removal.

Note: Chrysotile ASBESTOS is present in the Vinyl floor, External Damp Proof Course in the Kitchen Sink draining board and Condensation pad. Removal of these items to HSE guidance.

Cupboard inside the Existing Doctors Surgery has to be surveyed for ASBESTOS.

KEY

EXISTING FLOOR FINISHES KEY

- Existing Vinyl floor
- Existing Ceramic tiles
- Existing Timber floor in the Aisle room to be retained
- Existing Timber floor in the First floor to be retained
- Existing Vinyl floor in the First floor to be retained

EXISTING CEILING FINISHES KEY

- Existing Open ceiling in the First floor
- Existing Open ceiling in the First floor

- DOOR DOOR FRAME & ARCHITRAVE TO BE CAREFULLY REMOVED.
  - WINDOW WINDOW FRAME, CILL, GRILL AND BOARD UP TO BE CAREFULLY REMOVED.
  - HATCH HATCH FRAME & ARCHITRAVE TO BE CAREFULLY REMOVED.
- GROSS REFER TO THE ARCHITECT'S SPECIFICATIONS AND DETAILS.

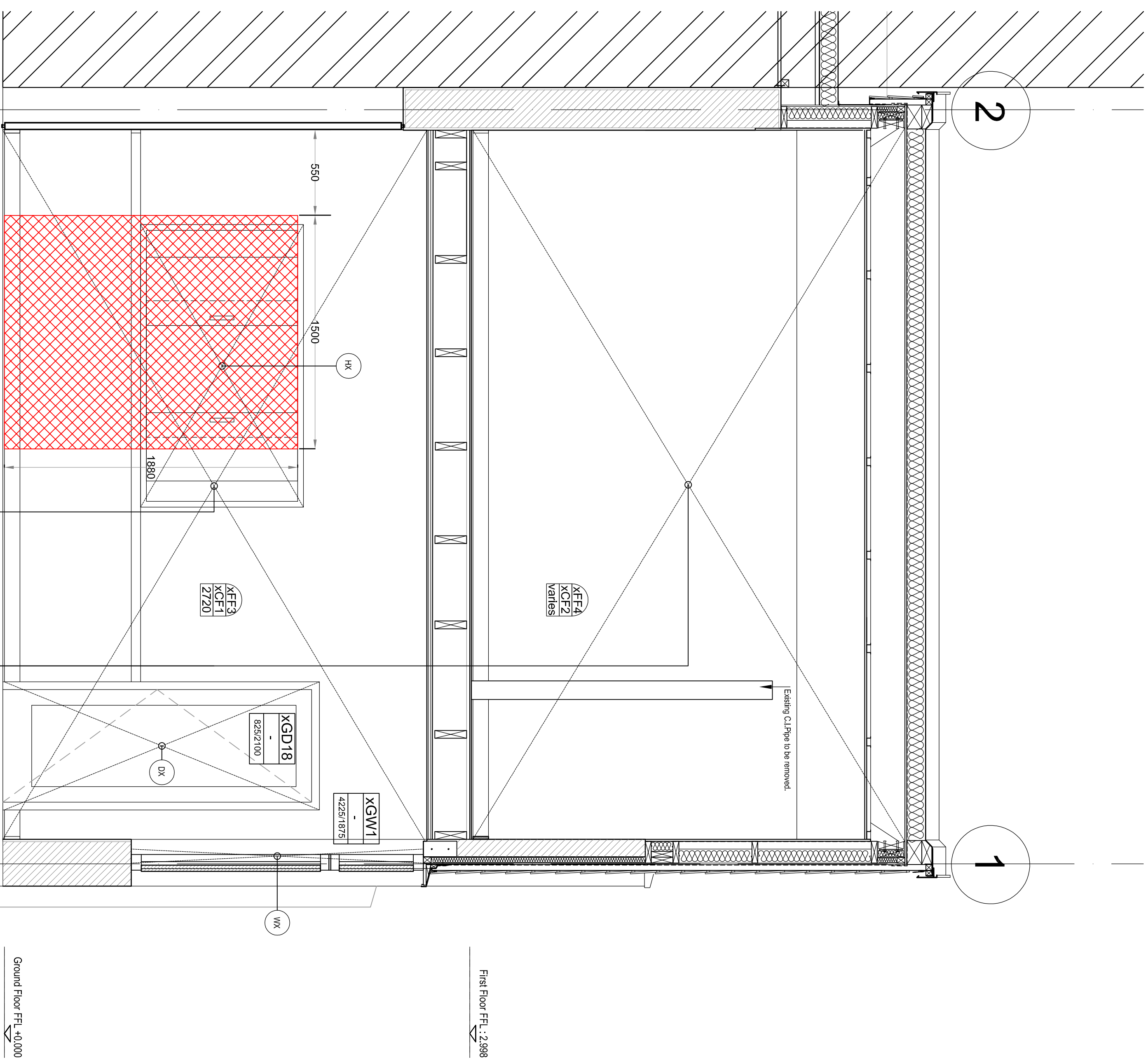

**1 Existing Section A A**

- 002 Aisle Room of Main Hall**  
Refer to the drawing GA260, for notes.
- 005 Storage Room**  
Refer to the drawing GA261, for notes.

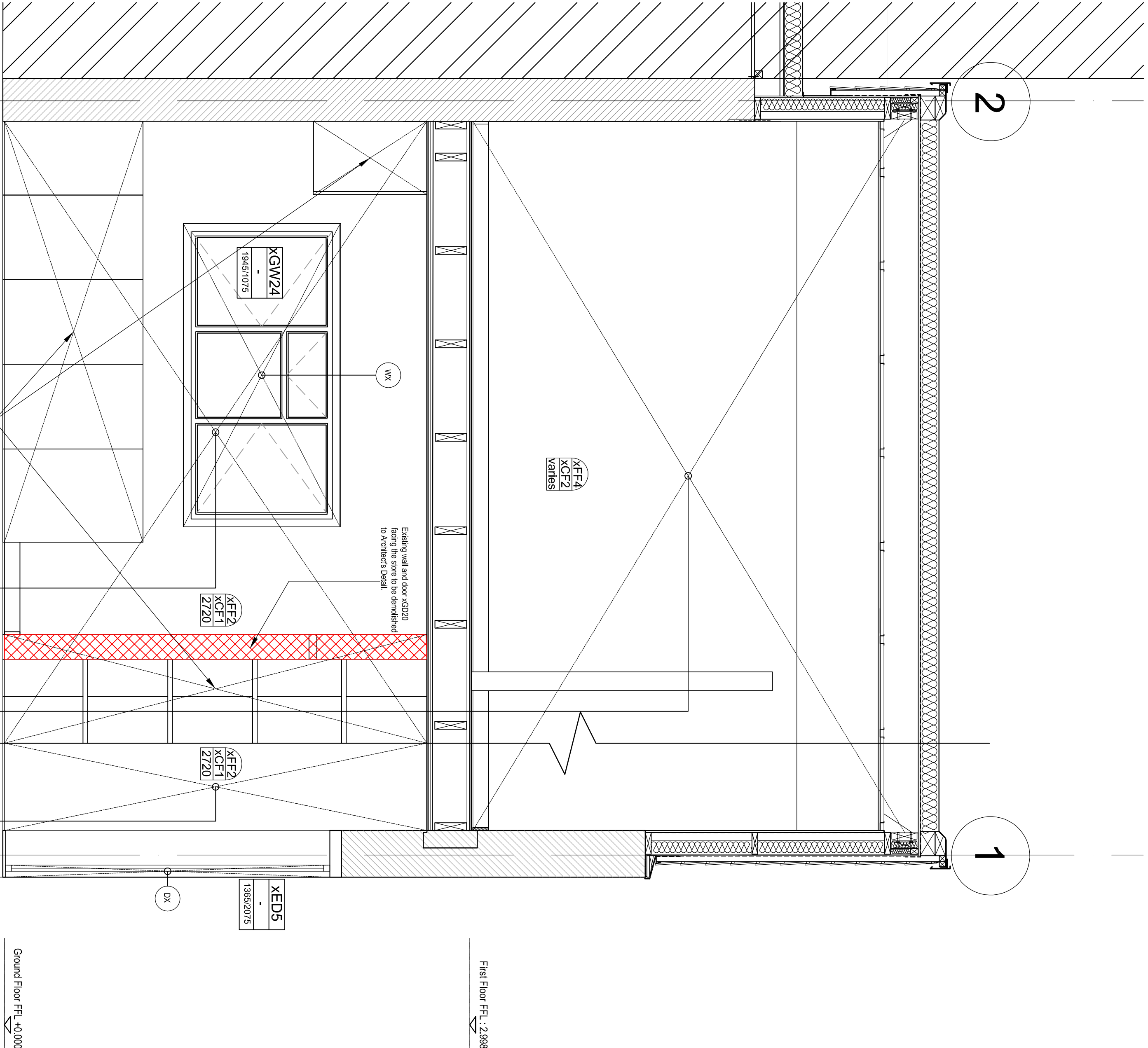

**2 Existing Section B B**

- 003 Kitchen with Store**  
Refer to the drawing GA260, for notes.
- 005 Storage Room**  
Refer to the drawing GA261, for notes.
- 004 Entrance foyer**  
Refer to the drawing GA260, for notes.

Existing Kitchen counters, Sink, Drain board and Stone worktops to be demolished. Chrysolite is present in the above mentioned items and to be removed in compliance with HSE guidelines.



**INDICATES THE EXISTING WALLS TO BE RETAINED**

**INDICATES THE WALLS FOR DEMOLITION WORKS**

**HATCH DENOTES AREA BOTH OUTSIDE CONTRACT & IN OCCUPATION BY CLIENT THROUGHOUT DEMOLITION & CONSTRUCTION WORKS**

**NOTE: EXISTENCE BRICK WORK TO BE REMOVED, CAREFULLY AND STORED FOR REUSING.**

**FOR TENDER**  
ISSUE DATE: 17/02/15

**Any deviations from drawings please contact Architect**

The drawing is copyright  
Rev. Date By Issue  
All dimensions are to be verified by the contractor before commencing work.

Project: High Halsow Village Hall - Phase 3  
Infillis and Alterations

**Clay Architecture Ltd**  
Great Lincs Studios, Louthborough Road NE7 3RH  
Tel: 01654 573 017 Fax: 01654 573 314  
email: design@clayarchitects.com

Scale: 1:20  
Date: 17/02/2015  
Drawing No: 5071/GA/263  
Revision: 00