

**KEY**

**BUILDING AND EXTERNAL FINISHES KEY**

**STRUCTURAL KEY**

**INTERNAL WALL FINISH KEY**

**INTERNAL PARTITION KEY**

**FLOOR FINISHES KEY**

**CEILING FINISHES KEY**

**DOORS & WINDOWS**

**DOOR WINDOW KEY**

**Any deviations from drawings please contact Architect**

**FOR TENDER**

ISSUE DATE: 17/02/15

**Clay Architecture Ltd**

High Halsow Village Hall - Phase 3

General Arrangement

New Ground Floor Plan

Scale: 1:25

Date: 17/02/2015

Drawn: SR

Checked: SR

Authorised: 00

5071/GA270

01

1:25

GA270

New Ground Floor Plan

01

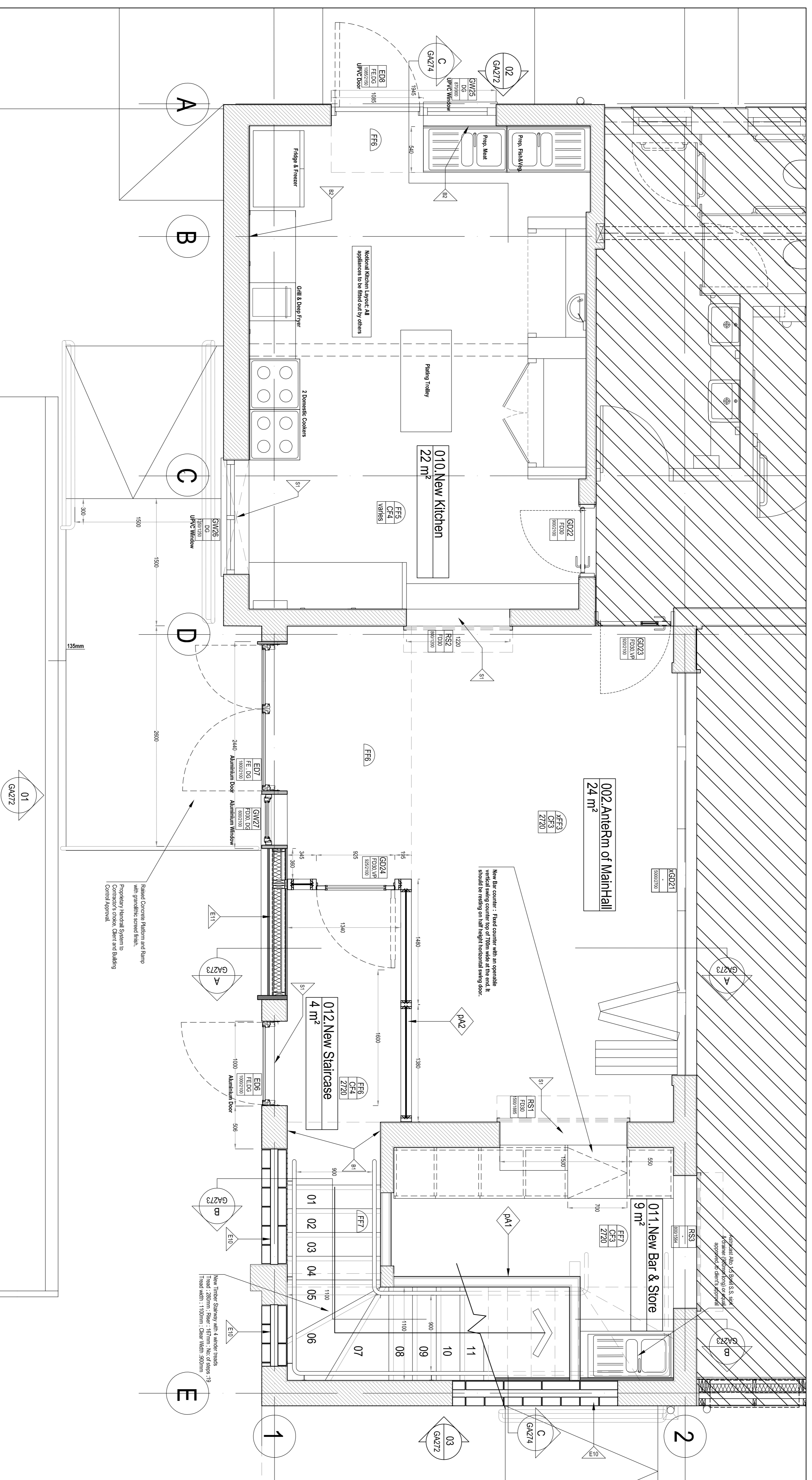

01  
GA270 1:25  
New Ground Floor Plan

The drawing is copyright  
All dimensions are to be verified by the contractor before commencing work.

Project:  
High Halsow Village Hall - Phase 3  
Infills and Alterations

**Clay Architecture Ltd**  
Great Lincs Studios, Louthborough Road NE7 7RH  
Tel: 01634 573 017 Fax: 01634 573 314  
email: design@clayarchitects.com

Scale: 1:25  
Date: 17/02/2015  
Drawn: SR  
Checked: SR  
Authorised: 00  
5071/GA270